

# The Plenty 2

4  2  2 



## Features

- ▶ 6 Star Energy Rating
- ▶ Gable roof design with raked ceilings to living areas
- ▶ Quality kitchen with built in pantry and stainless steel appliances
- ▶ Large range of finishings & options

## Dimensions

- ▶ Length: 17.4m
- ▶ Width: 8.0m
- ▶ Total Area (m<sup>2</sup>): 139.2m<sup>2</sup>
- ▶ Total Area (Sq): 15.0sq  
(Including porch, excluding optional verandah & carport shown)

Photographs and illustrations are intended to be a visual aid only. Fixtures, finishes & features may not be a standard inclusion. Verandahs, porches and/or decks may or may not be included; check floor plan. Landscaping not provided.



THE RIGHT HOME. THE RIGHT TIME.

Displays open Monday to Saturday, 10am - 4pm

816 Mountain Hwy, Bayswater, VIC, 3153

Ph: (03) 9720 1686 | Fax: (03) 9720 1690

E: [enquiries@toddddevine.com.au](mailto:enquiries@toddddevine.com.au)

ABN: 21 104 128 583

[www.toddddevine.com.au](http://www.toddddevine.com.au)

# The Plenty 2

4  2  2 

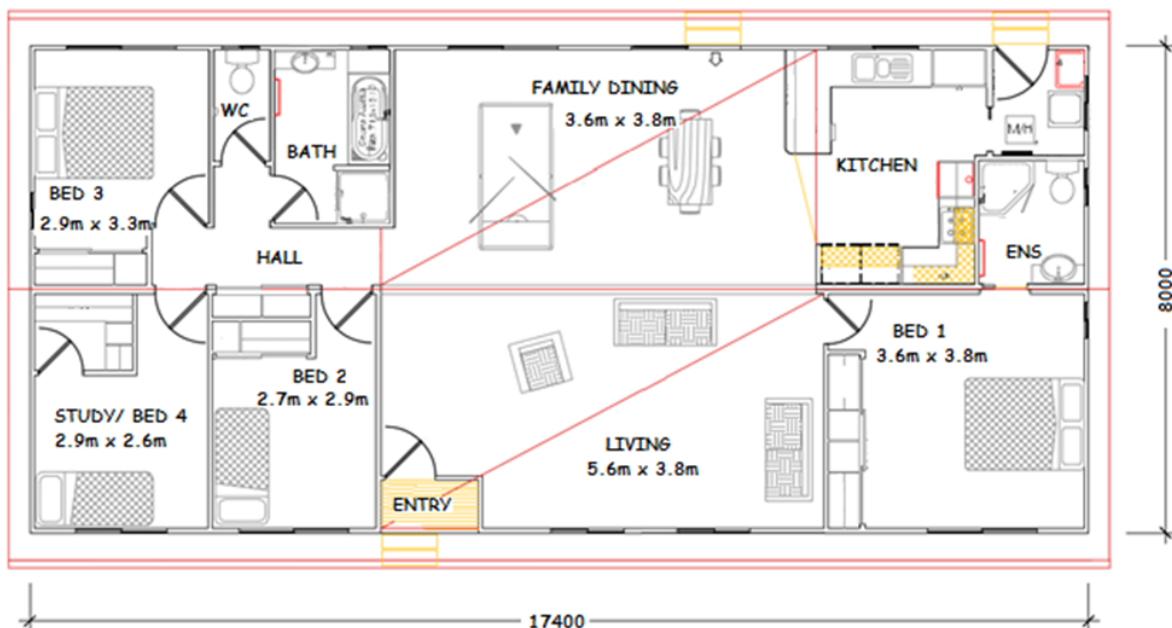

## Specifications

- ✓ 139.2 square meters floor space (incl. porch)
- ✓ Gable roof with raked ceiling to living areas (eaves)
- ✓ External cladding as James Hardie Primeline Chamfer Boards
- ✓ Colorbond roof with powder coated aluminium windows with insect screens
- ✓ Solid feature entry door off small porch with ½ glass to laundry
- ✓ Quality plasterboard walls with 55mm coved cornice
- ✓ Fully painted interior & exterior with gloss enamel to internal trim
- ✓ Full laminate kitchen with rolled formed bench tops, built in pantry & fridge/freezer provision
- ✓ Electric wall oven and electric cooktop with slide out range hood
- ✓ 1 1/3 bowl stainless steel sink with mixer tap set & right-hand draining area
- ✓ Ensuite – Corner shower with preformed base, tiled walls & glass pivot door, 300 wide semi recessed bowl vanity with mirror above, towel rail, dual flush toilet with toilet roll holder, fan/light heater & privacy lock to door
- ✓ Bathroom – 900 x 900 shower with preformed base, tiled walls & glass pivot door, bathtub, 300 wide semi recessed bowl vanity with mirror above, towel rail, fan/light heater & privacy lock to door
- ✓ Laundry – 45ltr tub, std washing machine provision
- ✓ Separate dual flush toilet with toilet roll holder & privacy lock to door
- ✓ All plumbing fixtures and fittings included
- ✓ Vinyl sliding door built in robe to bed 1 (2 x set of 4 shelves and hanging rails provided)
- ✓ Vinyl sliding door built in robe to bed 2 & 3 (1 x set of 4 shelves and hanging rail provided)
- ✓ Walk-in robe to bed 4 (4 shelves with hanging rail)
- ✓ Vinyl sliding door built in cupboard to hallway (8 x shelves)
- ✓ No floor coverings provided
- ✓ 250 litre electric hot water system, supplied loose
- ✓ Generous power and light points throughout
- ✓ 3000ltr slimline w/tank with pump to service sanitary flushings, supplied loose
- ✓ 6 star energy rated comfort



THE RIGHT HOME. THE RIGHT TIME.

Displays open Monday to Saturday, 10am – 4pm

816 Mountain Hwy, Bayswater, VIC, 3153

Ph: (03) 9720 1686 | Fax: (03) 9720 1690

E: [enquiries@todddevine.com.au](mailto:enquiries@todddevine.com.au)

ABN: 21 104 128 583

[www.todddevine.com.au](http://www.todddevine.com.au)