

# The Glenelg 2

3  1  1 



Picture for illustrative purposes only

## Features

- ▶ 6 Star Energy Rating
- ▶ Gable roof design with raked ceilings to living areas (Gable Eaves)
- ▶ Semi Ensuite to Master Bedroom with Bath
- ▶ Large range of finishings & options

## Dimensions

- ▶ Length: 13.0m
- ▶ Width: 6.6m
- ▶ Total Area (m<sup>2</sup>): 85.8m<sup>2</sup>
- ▶ Total Area (Sq): 9.25sq  
(Excluding verandah and garage)

Photographs and illustrations are intended to be a visual aid only. Fixtures, finishes & features may not be a standard inclusion. Verandahs, porches and/or decks may or may not be included; check floor plan. Landscaping not provided.



THE RIGHT HOME. THE RIGHT TIME.

Displays open Monday to Saturday, 10am - 4pm

816 Mountain Hwy, Bayswater, VIC, 3153

Ph: (03) 9720 1686 | Fax: (03) 9720 1690

E: [enquiries@todddevine.com.au](mailto:enquiries@todddevine.com.au)

ABN: 21 104 128 583

[www.todddevine.com.au](http://www.todddevine.com.au)

# The Glenelg 2

3  1  1 

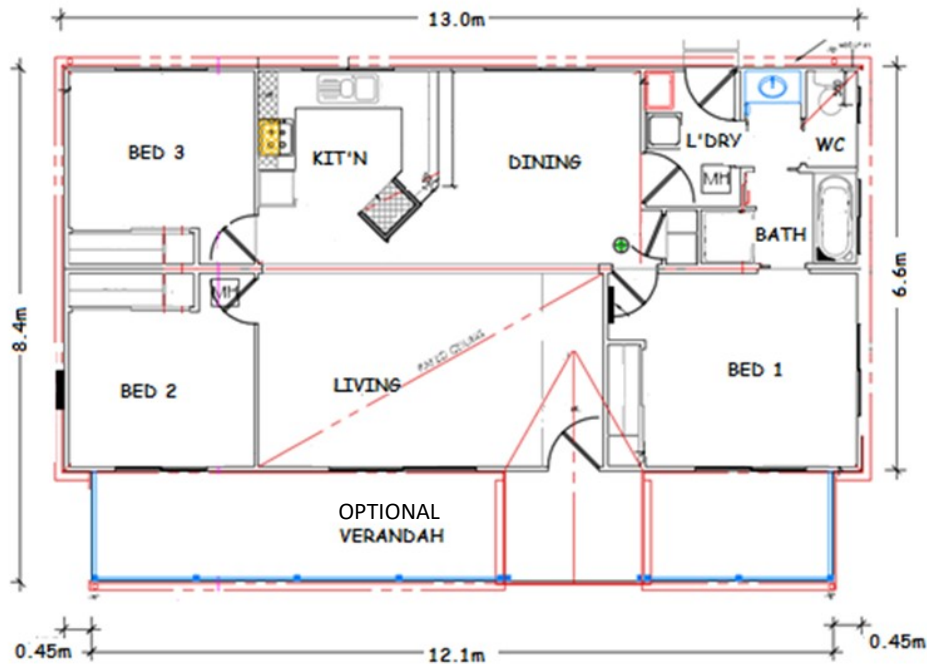

## Specifications

- ✓ 85.8 square meters floor space (excl verandah)
- ✓ Gable roof with raked ceiling to living areas
- ✓ External cladding as James Hardie Summit Primeline weather Boards
- ✓ Colorbond roof with powder coated aluminium windows with insect screens
- ✓ Solid feature entry door and ½ light door to laundry
- ✓ Quality plasterboard walls with 55mm covered cornice
- ✓ Fully painted interior & exterior (Gloss enamel to internal trim)
- ✓ Full laminate kitchen with rolled formed bench tops, built in pantry & fridge provision
- ✓ Electric under bench oven with electric cooktop and slide out range hood
- ✓ 1 1/3 bowl stainless steel sink with mixer tap set and left-hand drainer
- ✓ Bathroom – 900 x 900 shower with preformed base, tiled walls and glass pivot door built in bath with tiled splash back, separate double towel rail, fan/light heater and privacy lock to doors
- ✓ Separate full width vanity with decorative frieze tile and mirror above and towel ring
- ✓ Laundry - 45ltr tub with standard washing machine provision with overhead cupboards
- ✓ Separate dual flush toilet with toilet roll holder & privacy lock to door
- ✓ 250ltr electric hot water system
- ✓ Generous power and light points throughout
- ✓ 3000ltr slimline w/tank with pump to service sanitary flushings, supplied loose
- ✓ 6 star energy rated comfort



THE RIGHT HOME. THE RIGHT TIME.

Displays open Monday to Saturday, 10am - 4pm

816 Mountain Hwy, Bayswater, VIC, 3153

Ph: (03) 9720 1686 | Fax: (03) 9720 1690

E: [enquiries@toddevine.com.au](mailto:enquiries@toddevine.com.au)

ABN: 21 104 128 583

[www.toddevine.com.au](http://www.toddevine.com.au)